



EVOTECH®
P E R F O R M A N C E

Installation Instructions

YAMAHA YZF R3 2015 TAIL TIDY

Product Reference - 12665

Kit Contents

- | | |
|-------------------------------------|--|
| A 1 x Main Tail Tidy | H 2 x M6 - 25 Socket Button Heads |
| B 1 x Mounting Bracket | I 2 x M6 - 12 Socket Button Heads |
| C 1 x Reflector Bracket | J 2 x M3 - 12 Socket Button Heads |
| D 1 x LED Light Unit | K 2 x Plastic Nuts and Screws |
| E 1 x Wiring Loom Connector | L 2 x Male Bullet Connectors |
| F 2 x Long Mounting Spacers | M 4 x M6 Flange Nuts |
| G 2 x Short Mounting Spacers | N 8 x Cable Ties |

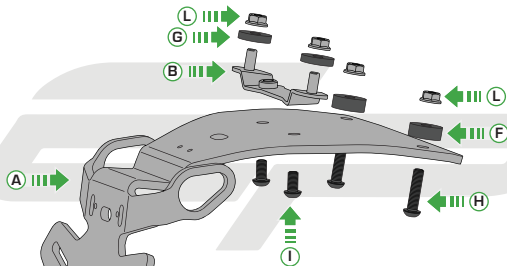

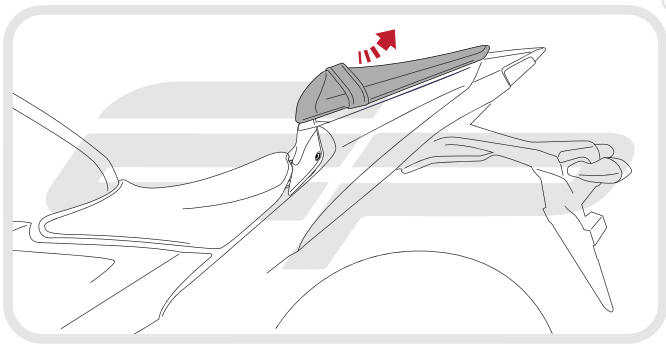

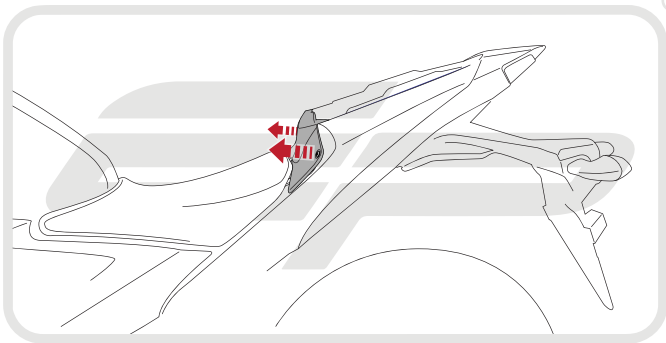

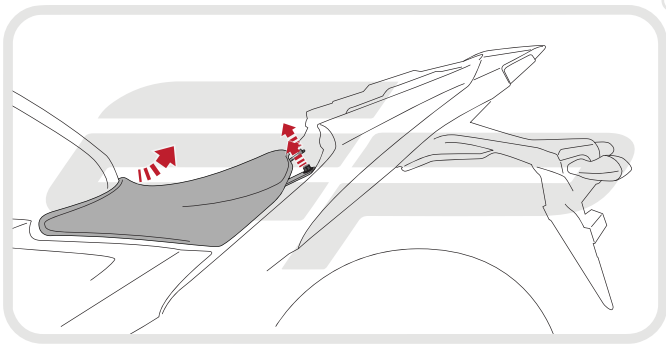

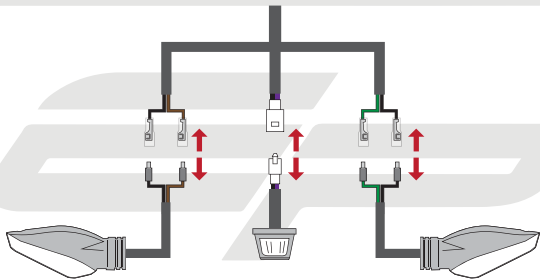

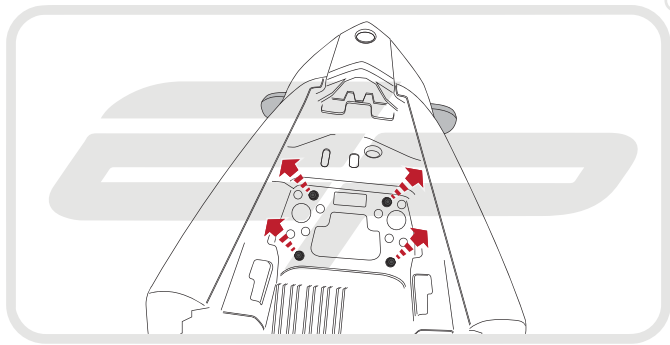

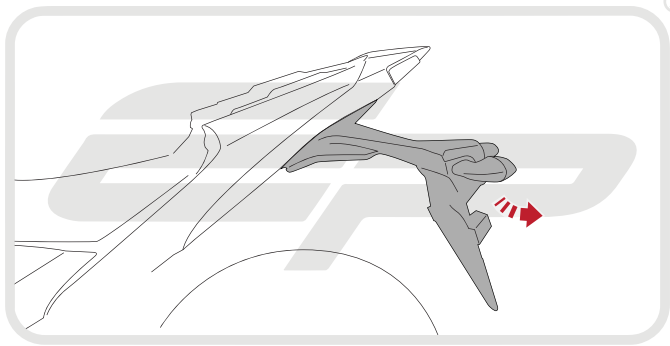

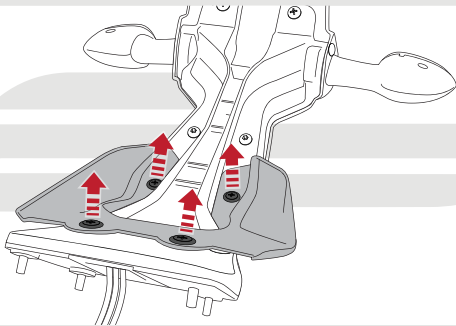

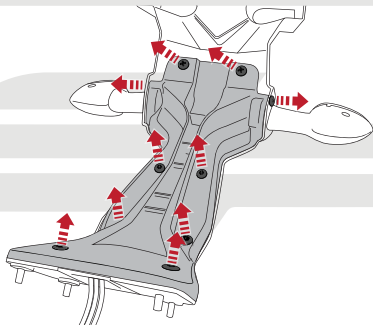

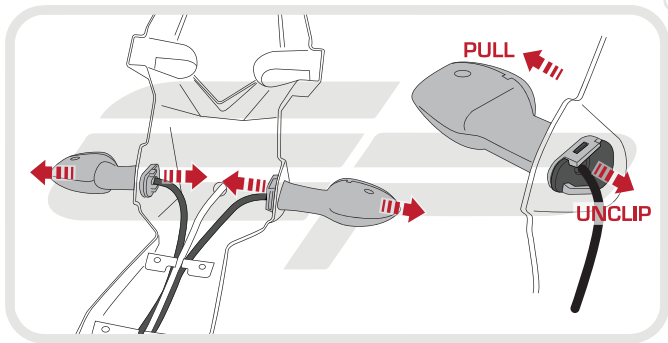



Ensure indicators are installed with the cut outs at the bottom of the indicator

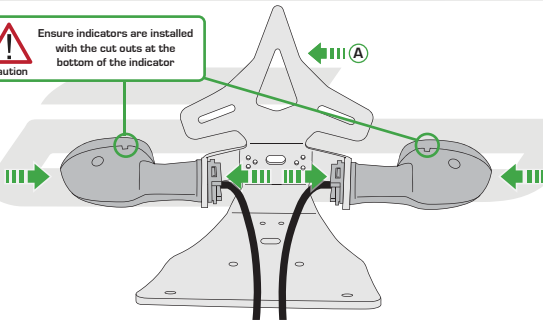



Caution

Loop cable ties through at
this stage but **DO NOT** close

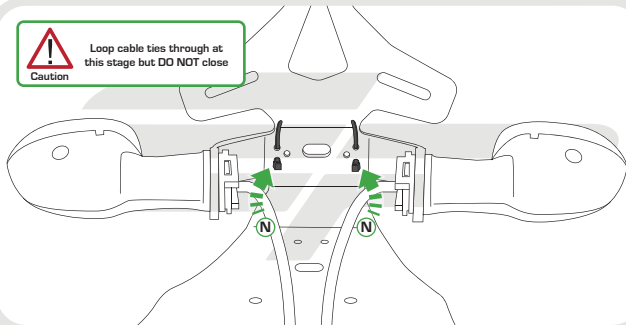

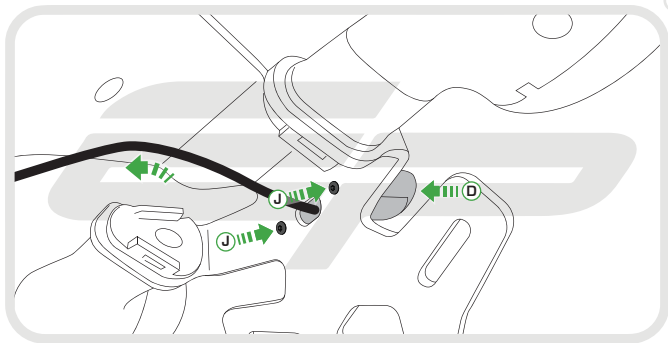



Caution

Close all cable ties ensuring
wires are not under
excessive tension

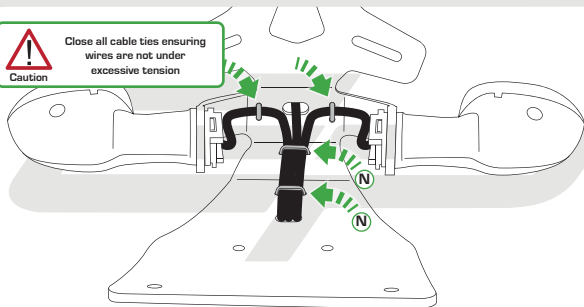

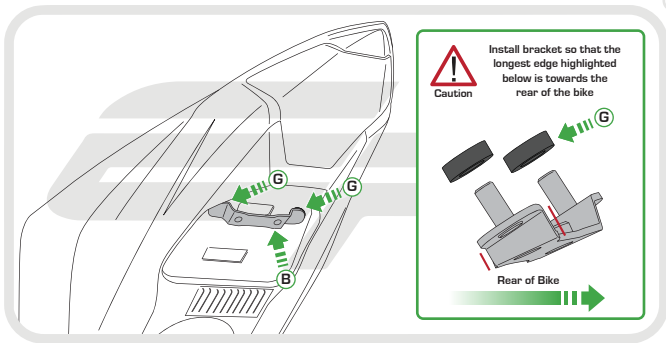

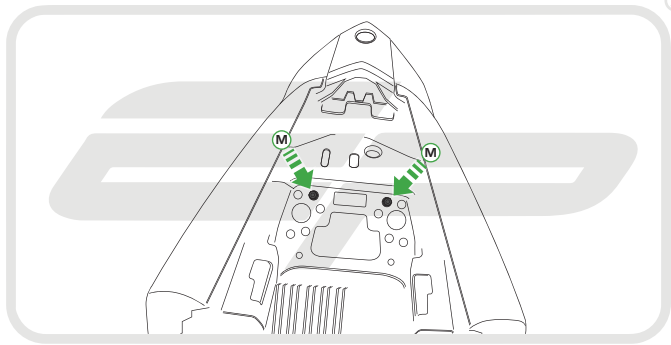



Caution

Feed the wires through the
undertray and into the
rear seat area

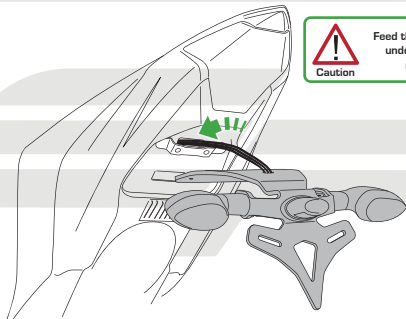

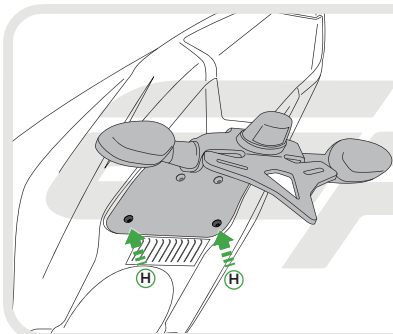

Caution

Ensure spacers are installed
between the tail tidy
and undertray

L



F



H



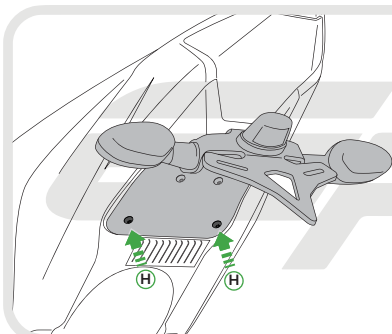

Caution

Ensure spacers are installed
between the tail tidy
and undertray

L



F



H



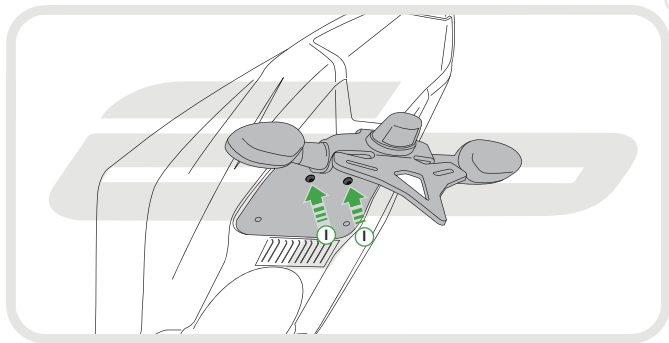

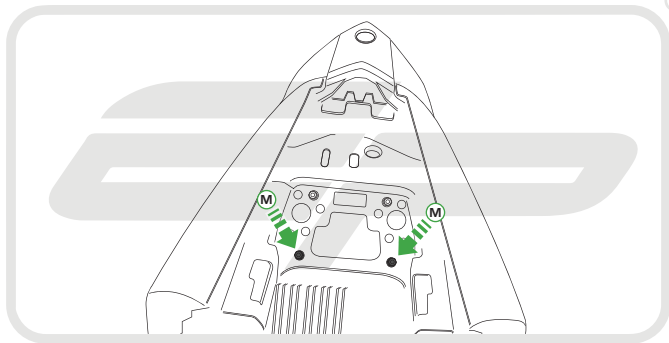

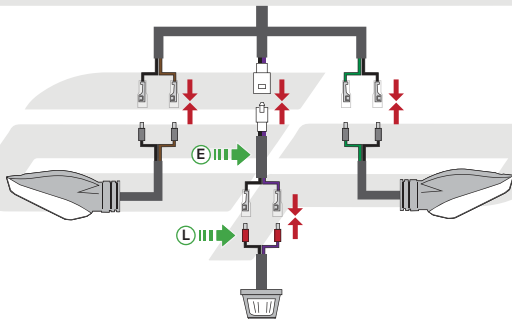



Reverse Stages
3, 2, 1

Reflector Bracket Installation

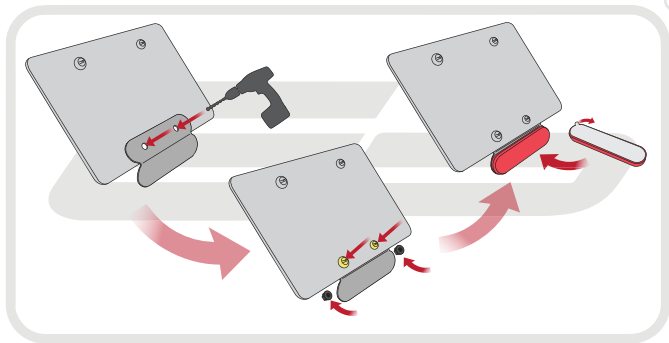

EVOTECH[®]
P E R F O R M A N C E



ESSENTIAL CHECKS



After installation of your tail tidy ensure that the licence plate does not contact the rear tyre when suspension is fully compressed.

Ensure all electrics including indicators, tail light, brake light and licence plate light lights are working correctly before riding the motorcycle.

It is recommended that periodic inspections are made to ensure that all fixings are fully tightend.



EVOTECH®
P E R F O R M A N C E

www.evotech-performance.com